

## Billet Aluminum GM Side Motor Mounts for g-Machine and Custom Crossmembers

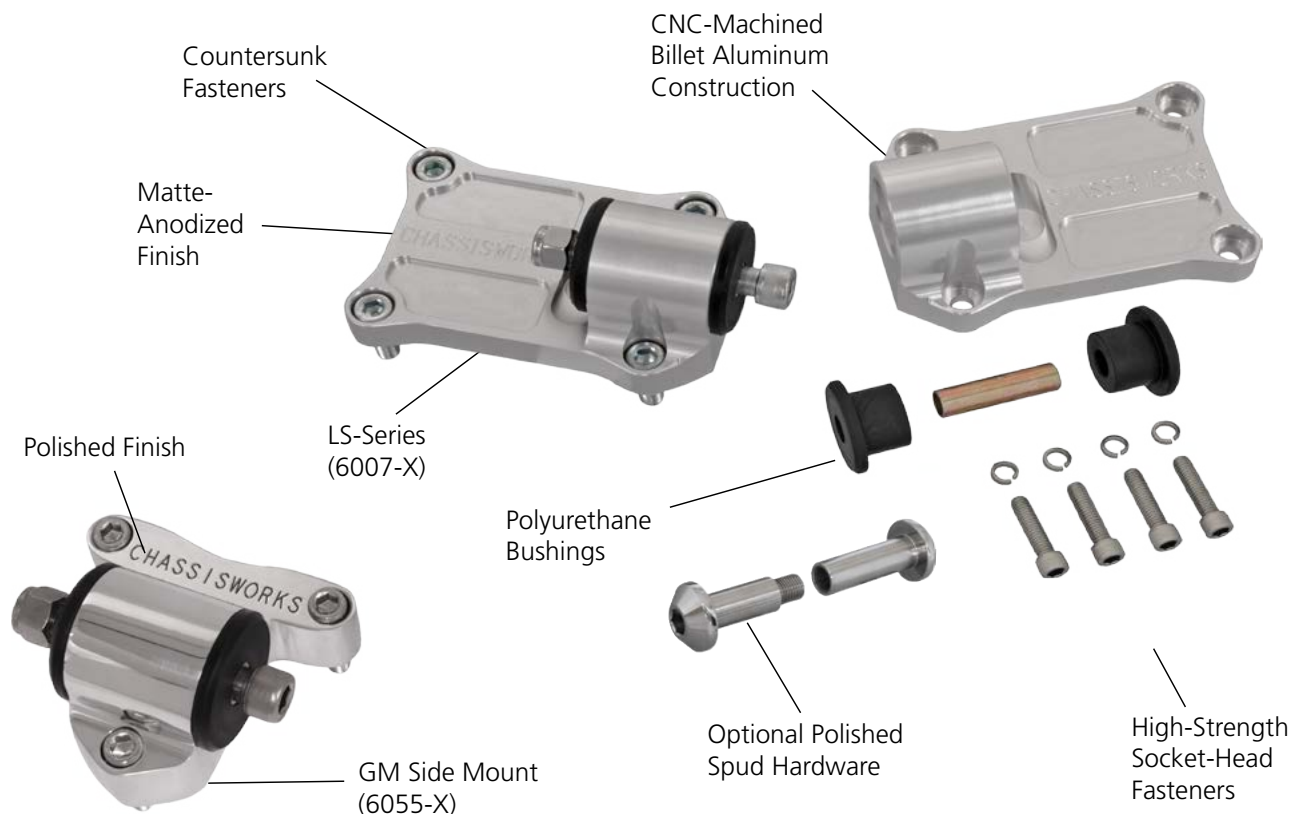

### Billet Side Motor Mounts

CNC-machined, billet-aluminum (steel Pontiac), side motor mounts enable bolt-on installation when used with our g-Machine crossmember, direct-fit subframes, or 2 x 2" mandrel-bent crossmember. Mounts are available with standard three-bolt pattern for Chevrolet V8 small-blocks and big-blocks and 4.3L V6s; four-bolt version to accommodate the modern LS-series of GM engines; and Pontiac 5-hole blocks from 1970 to 1977. The steel-sleeved, urethane bushing with 1/2" through-bolt design creates an inseparable mount with significant vibration reduction compared to solid mounts. Aluminum GM and LS mounts are available with matte-anodized or polished finish. Pontiac mounts are powder coated gloss black. Motor mount kits include all hardware.

**Chevrolet V8 Side Mounts, Billet Aluminum (Small Block, Big Block, 4.3L V6)**



**Chevrolet V8 Side Mounts**  
(Small Block, Big Block, 4.3L V6)

6055-0	Bare, Chevrolet Side Mounts (pair)
6055-1	Anodized, Chevrolet Side Mounts (pair)
6055-2	Polished, Chevrolet Side Mounts (pair)



**Pontiac Side Mounts, Billet Welded Steel (1970-77 5-Hole Blocks)**



**Pontiac V8 Side Mounts**  
(1970-77 5-Hole Blocks)

5917-PV8-S	Black Powder Coated, Pontiac Side Mounts (pair)
------------	---

**Chevrolet LS-Series Side Mounts, Billet Aluminum**

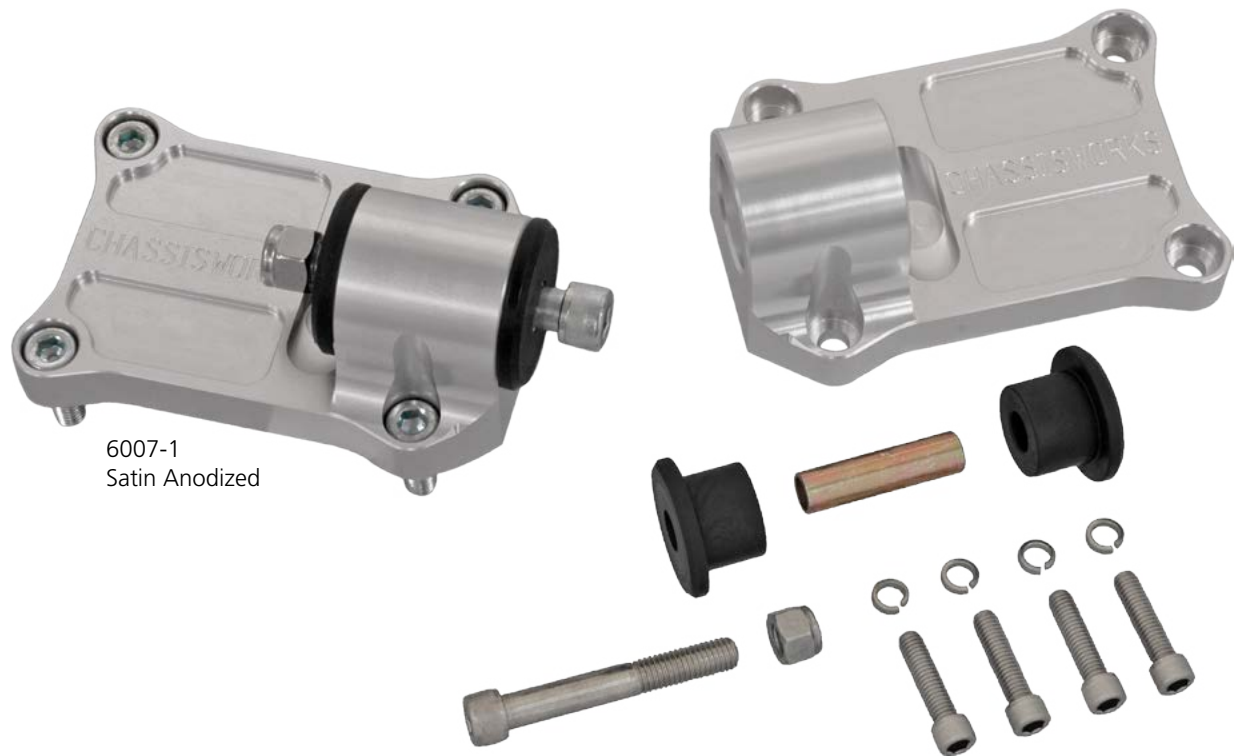

6007-1  
Satin Anodized

**Chevrolet LS-Series Side Mounts, Billet Aluminum**

6007-0	Bare, LS-Series Side Mounts (pair)
6007-1	Anodized, LS-Series Side Mounts (pair)
6007-2	Polished, LS-Series Side Mounts (pair)



6007-2  
Polished Finish

## 2 x 2" Custom Engine Crossmember

Constructed of .120"-wall, 2 x 2" tube, this mandrel-bent crossmember is 42" wide (and can easily be shortened if necessary), fits LS-series and small- and big-block Chevy engines, and provides 6" of oil-pan clearance from the bottom of the engine block to the top of the crossmember drop. The passenger side of the crossmember has an adjustment slot in the motor-mount tabs to facilitate engine installation. Uses billet side mounts (6007-X or 6055-X) and optional spud hardware (3046).

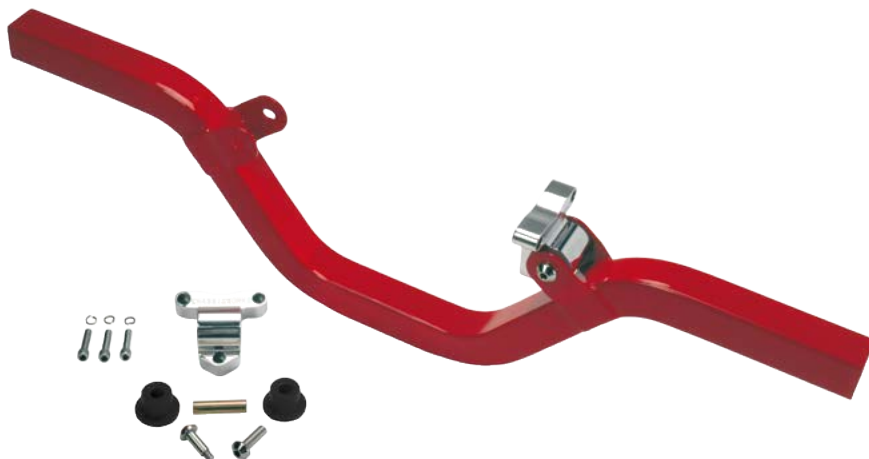

6060	2 x 2 x .120"-wall, 42"-wide, Engine Crossmember (cut to fit)
------	---

## Motor-Mount Spud Hardware (Optional)

Specially designed, CNC-machined, polished-stainless-steel mounting hardware is optionally available for use with our billet aluminum side motor mounts. Male and female fasteners feature matching Allen-drive, beveled heads for simple installation and excellent appearance. Once tightened against each other, fasteners form a full-length shank with no external threads, providing higher shear strength than standard bolts and correct bushing preload.

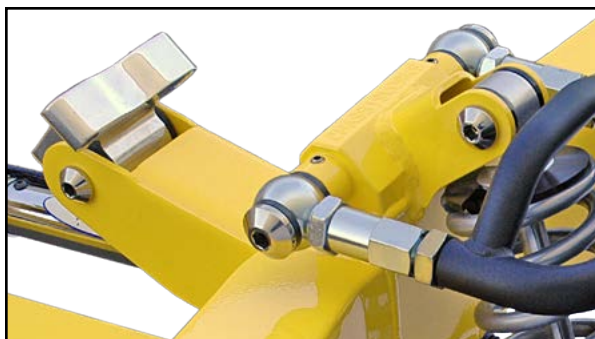

5917-SP277	Motor-Mount Spud Hardware Set, Chevrolet Side Mount (6007 or 6055), Polished Finish
------------	---

All prices subject to change. Current pricing available at [www.cachassisworks.com](http://www.cachassisworks.com).



Chris Alston's Chassisworks, Inc.  
8661 Younger Creek Drive  
Sacramento, CA 95828

Order: 800-722-2269  
Tech: 916-388-0288  
Fax: 916-388-0295

[sales@cachassisworks.com](mailto:sales@cachassisworks.com)  
[www.cachassisworks.com](http://www.cachassisworks.com)